



**DURA PRODUCTS**  
Technology with Lasting Value

6660 E 266th Street, Suite 300 | Arcadia, IN 46030  
855-502-3872 | [www.DuraProducts.com](http://www.DuraProducts.com)



2017



**DURA PRODUCTS**  
Technology with Lasting Value

**MASTER CATALOG**

2017



## DURA PRODUCTS

Technology with Lasting Value

Dura Products is an Indiana based manufacturer of state-of-the-art metering, pumping and dispensing systems. All products are manufactured right here in America's heartland and are sold under the company's flagship Dura brand. Founded by owners with decades of knowledge in farming and the chemical sales industry, Dura Products prides itself on innovative, versatile and durable designs with the end customer always in mind.



## DURA PRODUCTS

Technology with Lasting Value

6660 E 266th Street, Suite 300 | Arcadia, IN 46030  
855-502-3872 | [www.DuraProducts.com](http://www.DuraProducts.com)



Visit [www.DuraProducts.com](http://www.DuraProducts.com) for full disclosure of terms and conditions.

**ORDERING:** Call (855) 502-3872, fax (317) 984-7868 or email [CustomerService@DuraProducts.com](mailto:CustomerService@DuraProducts.com). All orders received by 1:00 p.m. Eastern Standard will be shipped that day unless the item is on back-order. If the item is on back-order, you will receive a call to discuss whether you want an alternate product or would prefer to wait on the back-ordered item.

**SHIPPING:** A full pallet (consisting of 25 systems) is delivered via a freight carrier. Incomplete pallets may be delivered via freight carrier, UPS Ground or FedEx Ground depending on which is the most economical for you. Shipping is FOB Arcadia, IN.

**WARRANTY:** All Dura Products equipment is covered by a two year warranty from the date of manufacture. For warranty consideration, call (855) 502-3872 (DURA) to request a Return Goods Authorization (RGA) form and follow the instructions on the form to ship the item back for a Warranty Evaluation. Once the evaluation is complete (in approximately three weeks), the item will either: 1. Be repaired or replaced at no cost to you and returned, or 2. You will be contacted to discuss an item that is not covered by the warranty. We offer a fully functional repair department that can repair your non-warranty claim item or we can arrange to properly dispose of the item. *Pumps sent in for warranty must have all hoses and nozzles detached from the pump. Drain and flush all pumps/units/meters of all liquids as best as you can. Each item MUST be placed in a tied garbage bag before being placed into shipping container. DO NOT send hoses and nozzles in with pumps for repair. Shipping to and from the warranty repair center is the responsibility of the customer.*











NEW FOR  
**2017**  
DURA-ABS™  
**AUTO-BATCH SYSTEM**

The industry's **only** transfer system offering an **automated** dispensing option



PREMIUM  
**HIGH-FLOW**  
AG CHEMICAL  
**TRANSFER SYSTEMS**

UP TO  
**15GPM**

 <b>STAINLESS STEEL RSV DIS- PENSE COUPLER THREADED LIQUID VERTICAL OUTLET</b> DP-R5072 EPDM	 <b>STAINLESS STEEL RSV DISPENSE COUPLER BARBED LIQUID OUTLET</b> DP-R3713 EPDM	 <b>POLY RPV DISPENSE COUPLER BARBED LIQUID OUTLET</b> DP-R3714 EPDM	 <b>STAINLESS STEEL RSV FILL COUPLER</b> DP-R4027 EPDM	 <b>DEF DURA-METER™ FACE PLATE</b> DP-MFP01-D
 <b>DEF STAINLESS AUTO SHUT-OFF NOZZLE WITH STAINLESS STEEL SPOUT AND SWIVEL</b> DP-N4001	 <b>DEF POLY AUTO SHUT-OFF NOZZLE WITH STAINLESS STEEL SPOUT AND SWIVEL</b> DP-N4005	 <b>DEF POLY MANUAL NOZZLE WITH STAINLESS STEEL SPOUT AND POLY SWIVEL</b> DP-N4003	 <b>DEF POLY MANUAL NOZZLE WITH POLY SPOUT</b> DP-N4006	 <b>DEF DURA-PUMP™ BOTTOM HOUSING KIT WITH BOTTOM GASKET AND SCREWS</b> DP-H4001A-E EPDM
 <b>STAINLESS STEEL RSV CONTAINER VALVE 2.5" X 5" BUTTRESS THREAD</b> DP-R4097-E EPDM	 <b>POLY RPV CONTAINER VALVE 2.5" X 5" BUTTRESS THREAD</b> DP-R2682 EPDM	 <b>DEF DURA-PUMP™ GASKET KIT</b> DP-G4001A-E EPDM	 <b>DEF DURA-PUMP™ CARTRIDGE KIT WITH O-RING AND BOTTOM GASKET</b> DP-P4017A-D	 <b>TAMPER EVIDENT SEALS</b> DP-P5500 100 PACK DP-P5501 10 PACK
 <b>6" IBC CAP WITH 2" BUTTRESS BUNG</b> DP-C4001B-E	 <b>6" IBC CAP WITH MANUAL VENTED LID AND 2" BUTTRESS BUNG</b> DP-C4004B-E	 <b>6" IBC CAP WITH MANUAL VENTED LID AND RPV CONTAINER VALVE</b> DP-C4003B-E	 <b>6" IBC CAP WITH 2" NPT BUNG</b> DP-C4009B-E	 <b>6" IBC CAP WITH DUAL ACTION VENT</b> DP-C4010B-E
 <b>STAINLESS STEEL RSV CONTAINER VALVE TOOL INSTALL/REMOVAL</b> DP-R4084	 <b>BUTTRESS TO NPT ADAPTER 2" X 2"</b> DP-A4001	 <b>EASY SEAL DUAL ACTION AUTO VENT 2" NPT</b> DP-V4002	 <b>DEF DOWN TUBE</b> 55 Gallon Drum 32" Length DP-T4810 135 Gallon IBC Tote 22" Length DP-T3810 275 Gallon IBC Tote 37.8" Length DP-T4960 330 Gallon IBC Tote 45" Length DP-T4135	
 <b>1" NPT TELESCOPING DOWN TUBE</b> DP-T4001	 <b>DEF 135 GALLON TANK</b>	 <b>DEF 275 GALLON TANK</b>	 <b>DEF 330 GALLON TANK</b>	

Tanks available upon request



# NEW FOR 2017

The industry's **only** transfer system offering an **automated** dispensing option



## DURA-ABS™ AUTO-BATCH SYSTEM

- / Intuitive interface allows for the selection of manual or automatic operation with the flip of a switch
- / High-flow pump with up to 15GPM flow rate
- / Optimized for repeatable batching; returns to the last volume amount dispensed
- / 100% moisture sealed circuitry
- / Includes Dura-Meter™ with impact resistant Lexan™ faceplate
- / Available in 12 Volt or 110 Volt, and EPDM or Viton® options
- / Features a 2 year warranty



DPABS-4312 12 Volt | DPABS-4315 110 Volt

(Available in EPDM or Viton®)

Must specify EPDM (product # and E) or Viton® (product # and V) when ordering.

## HOW IT WORKS

- 1 Select the volume desired
- 2 Press START
- 3 The pump will begin to dispense fluid and automatically shuts off when complete.



## DEF DURA-METER™

- / 100% Moisture-sealed circuitry makes meter impervious to water intrusion
- / Meter calibrated for DEF
- / Same great menu driven backlit display
- / Plumbed for both in-line and 90 degree applications
- / Includes 2 Year Warranty

DP-3000D

### Specifications

Operating Temp	-10°F to 130°F
Flow Rate	2 to 22GPM
ISO22241-3 Compliant	Yes
Meter Accuracy	+ / - .5%
Maximum Pressure	40 PSI
Wetted Materials	Polypropylene; 304 Stainless Steel; Ryton; EPDM seals



## DEF DURA-PUMP™

- / High-Flow pump with up to 15GPM free flow rate and 10+GPM with 3/4" discharge hose and nozzle
- / Self-priming diaphragm pump with internal bypass
- / Motor thermally protected from overheating
- / 30 minute duty cycle
- / Suction ports has 2" Male NPT and 1" Female NPT
- / Pump is easily field serviceable
- / 10 minute auto-shut off available (110V only)
- / Includes 2 Year Warranty

DEF-2012E 12 Volt | DEF-2015E 110 Volt

### Specifications

Check Valve	Internal; EPA 165.45 compliant
Vertical Suction Lift	Self-priming to 10ft
Power Cord	12 Volt: 20ft; 110 Volt: 6.5ft
Motor	1/4 HP
Amps	12 Volt: 18.5; 110 Volt: 2.0
Suction Port	2" Male and 1" Female NPT thread
Discharge Port	1" Female NPT thread
ISO22241-3 Compliant	Yes
Wetted Materials	Polypropylene; Santoprene; 304 Stainless Steel; EPDM seals





# DEF DURA-PUMP™ 135 PORTABLE TOTE

PREMIUM HIGH-FLOW DEF DISPENSING SYSTEMS 10+ GPM



# ALL-IN-1

**COMPLETE SYSTEM** to  
TRANSPORT, DISPENSE & STORE  
DIESEL EXHAUST FLUID

Pumping System Contains	
135 Gallon Tote	Specially designed to maintain the strictest purity of DEF
Pump System	ISO/EPA compliant DEF Easy Caddy pumping system
Coupler	RPV; MicroMatic
Discharge Hose	3/4" x 20ft
Suction Hose	3/4" x 1.5ft
Lid	6"; Vented
Nozzle	Manual or Automatic
Meter	DEF Dura-Meter™ (optional)
Other	All hose clamps and fittings



/ Includes 2 Year Warranty

MANUAL Nozzle	AUTOMATIC Nozzle
DEFE-2512ME-135 12 Volt	DEFE-2512AE-135 12 Volt
DEFE-2515ME-135 110 Volt	DEFE-2515AE-135 110 Volt

DEF Dura-Meter™ DP-3000D (sold separately)

Tote, Lid and Container Valve INCLUDED



# LIMITLESS APPLICATIONS

Use **individual units** for **simple** applications

Use **multiple units** to create an **automated process** for dispensing into an inductor cone

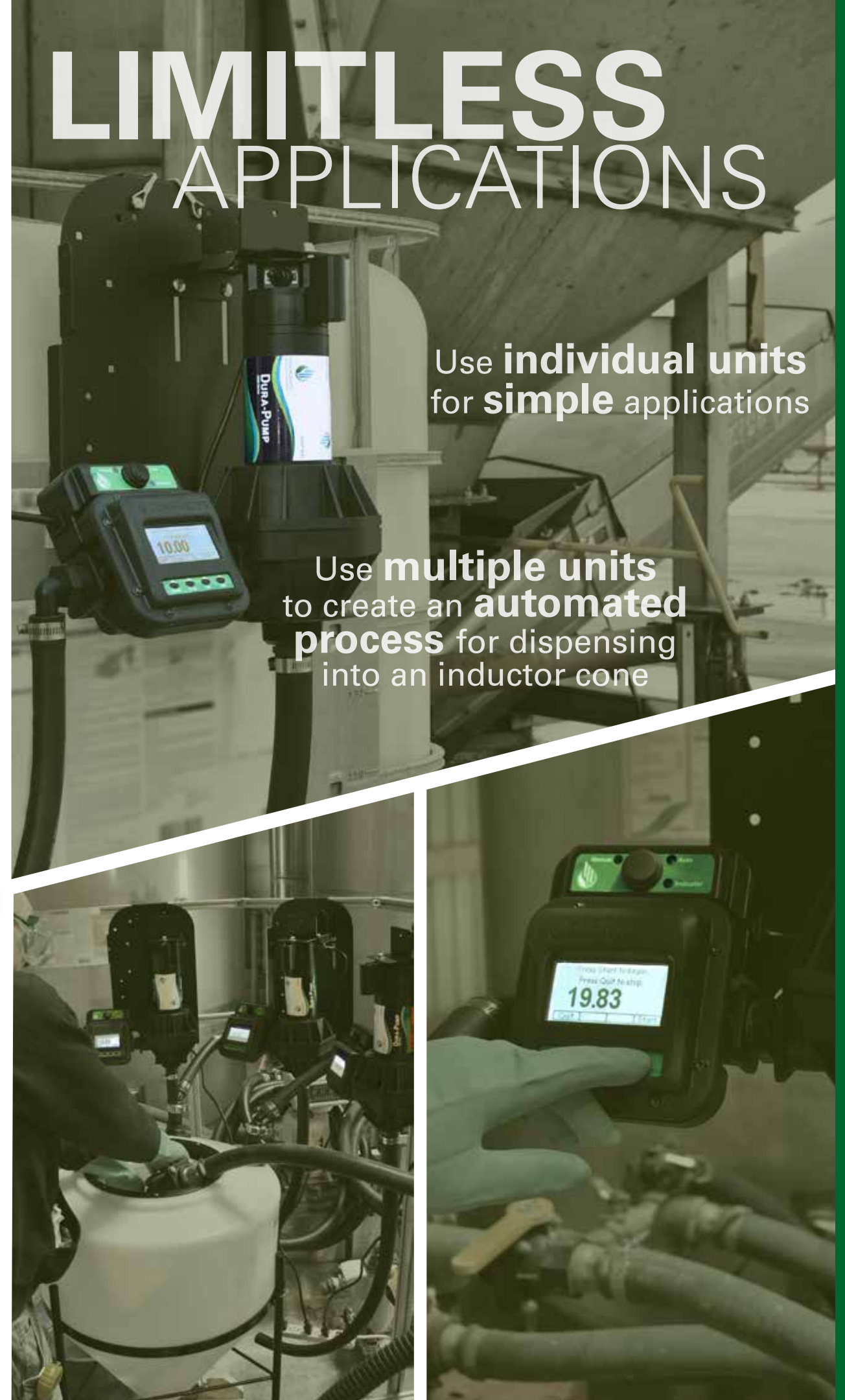

AG CHEMICAL METERS & PUMPS





# DEF DURA-PUMP™ TOP UNLOAD



## DURA-METER™

- / Made of impact resistant Lexan™ faceplate
- / 100% moisture-sealed circuitry makes meter impervious to water intrusion
- / Menu driven backlit display
- / Plumbed both for in-line and 90 degree applications
- / Includes 2 Year Warranty



DP-3000E EPDM | DP-3000V Viton®

Must specify EPDM (product # and E) or Viton® (product # and V) when ordering.

Specifications	
Operating Temp	-10°F to 130°F
Flow Rate	2 to 22GPM
Meter Accuracy	+ / - .5%
Backlit Display	Yes
Maximum Pressure	40 PSI
Wetted Materials	Polypropylene; 304 Stainless Steel; Ryton; EPDM or Viton® seals

### Special Features

- / Supported by a Quick List reference chart
- / Extended battery life with use of 4 "AAA" batteries
- / Faceplate over-molded with Santoprene and filled with gel for improved shock resistance

Customer should always check calibration before use



/ Includes 2 Year Warranty

### Pumping System Contains

10+ GPM Pump	High-Flow Dura-Pump™
Coupler	RSV; MicroMatic with RSV model
Downtube	1" Telescoping with non-RSV model
Nozzle	Manual or Automatic
Discharge Hose	3/4" x 20ft
Meter	DEF Dura-Meter™ (optional)
Other	All hose clamps and fittings

Meter, Totes, Drums, Lid and Container Valves sold separately



#### Without RSV Coupler

MANUAL Nozzle	AUTOMATIC Nozzle
DEFT-2012ME 12 Volt	DEFT-2012AE 12 Volt
DEFT-2015ME 110 Volt	DEFT-2015AE 110 Volt

DEF Dura-Meter™ DP-3000D (sold separately)



#### With RSV Coupler

MANUAL Nozzle	AUTOMATIC Nozzle
DEFT-2412ME 12 Volt	DEFT-2412AE 12 Volt
DEFT-2415ME 110 Volt	DEFT-2415AE 110 Volt

DEF Dura-Meter™ DP-3000D (sold separately)



# DEF DURA-PUMP™ EASY CADDY TOP SUCTION

For totes with RPV type valve

PREMIUM HIGH-FLOW DEF DISPENSING SYSTEMS 10+ GPM



**TOP MOUNT**  
Easy Caddy secured  
on top of 330 tote  
and 135 tote



Pumping System Contains	
10+ GPM Pump	High-Flow Dura-Pump™
Coupler	RPV; MicroMatic
Discharge Hose	3/4" x 20ft
Suction Hose	3/4" x 1.5ft
Nozzle	Manual or Automatic
Meter	DEF Dura-Meter™ (optional)
Other	All hose clamps and fittings

/ Includes 2 Year Warranty

MANUAL Nozzle	AUTOMATIC Nozzle
DEFE-2512ME 12 Volt	DEFE-2512AE 12 Volt
DEFE-2515ME 110 Volt	DEFE-2515AE 110 Volt

DEF Dura-Meter™ DP-3000D (sold separately)

Meter, Totes, Drums, Lid and  
Container Valves sold separately



## DURA-PUMP™

- / High-Flow with up to 15GPM flow rate
- / Self-priming diaphragm pump with internal by-pass
- / Motor thermally protected from overheating
- / 30 minute duty cycle
- / Suction port has 2" Male NPT and 1" Female NPT
- / Pump is easily field serviceable
- / Includes 2 Year Warranty

DP-4012 12 Volt | DP-4015 110 Volt

(Available in EPDM or Viton®)

Must specify EPDM (product # and E) or  
Viton® (product # and V) when ordering.

### Specifications

Check Valve	Internal; EPA 165.45 compliant
Vertical Suction Lift	Self-priming to 10ft
Power Cord	12 Volt: 20ft; 110 Volt: 6.5ft
Motor	1/4 HP
Amps	12 Volt: 18.5; 110 Volt: 2.0
Suction Port	2" Male and 1" Female NPT thread
Discharge Port	1" Female NPT thread
Wetted Materials	Polypropylene; Santoprene; EPDM or Viton® seals; 304 Stainless Steel

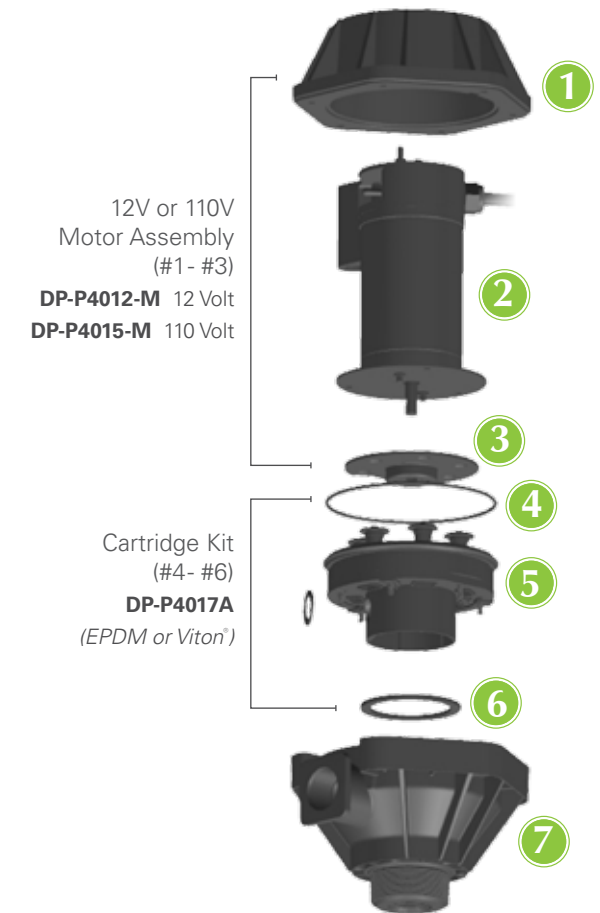

- Upper Housing  
DP-P4002A
- 12V or 110V Motor
- Drive Plate
- O-ring  
DP-P4004AO (EPDM or Viton®)
- Cartridge  
DP-P4017A (EPDM or Viton®)
- Bottom Gasket  
DP-P4001AG (EPDM or Viton®)
- Bottom Housing  
DP-H4001A (EPDM or Viton®)





# DURA-PUMP™ EASY CADDY

1



**SIDE MOUNT**  
Easy Caddy secured  
on side of tote

The Easy Caddy system is our **top selling** and the industry's **most versatile** chemical transfer system



Pumping System Contains	
Pump	High-Flow Dura-Pump™
Suction Hose	1" x 5ft
Discharge Hose	1" x 12ft
Nozzle	Ball valve
Camlock	2"
Meter	Dura-Meter™ (optional)
Other	All hose clamps, barbs and nipples



PREMIUM  
**HIGH-FLOW**  
**DEF**  
DISPENSING  
SYSTEMS



**PORTABLE**  
DEF STORAGE  
SOLUTIONS



# DURA PRODUCTS AG CHEMICAL CHART

COMPOUND	EPDM	VITON®
Atrazine	●	●
Degree Xtra®	●	●
FulTime® NXT	●	●
Callisto® 480SC	●	
Lexar® EZ	●	
Lumax® EZ	●	
Halex® GT	●	
Instinct®		●
Stylet-Oil		●
Shredder™ E-99		●
2,4-D Ester		●
Max-In® Ultra ZMB	●	●
MSO, Crop Oil, Oil Based		●
Roundup®	●	●
SureStart®	●	●
Matador		●
Foliars		●
Nitrogen based		●
Fungicides		●

The Dura Products Chemical Compatibility Chart **should be considered as a guide only** due to the many variables which may affect the compatibility of materials. This guide is based on the most recent information obtained from a variety of suppliers and chemical producers and is believed to be accurate. Actual decisions on materials used need to be tested and evaluated by the customer for each specific application. The responsibility of proper chemical compatibility of equipment and material used is the full responsibility of the customer. Dura Products does not warrant product damaged by non-compatibility.

For a more comprehensive listing of chemicals, please visit our website at [www.DuraProducts.com](http://www.DuraProducts.com)

For help with the proper selection of pump for your application needs, please call 855-502-3872

# SYSTEM



**TOP MOUNT**  
Easy Caddy secured  
on top of tote



**GROUND**  
Easy Caddy used  
from the ground

# USE IT

- / The Easy Caddy can be mounted in 6 different configurations on a variety of tank/tote and drum types
- / Use it mounted on top of tank or on top of a 55 gallon drum, on the side of tank, or off the ground depending on user preference
- / Conversion Kits are available to mount system on Monsanto or Snyder type tanks (see pg. 15)
- / Includes 2 Year Warranty



**SNYDER TANK**  
Easily converted to a GEM Cap

**MONSANTO TANK**  
Easily converted to a MTS

WITH Meter	WITHOUT Meter
DPEM-4312 12 Volt	DPE-4012 12 Volt
DPEM-4315 110 Volt	DPE-4015 110 Volt

(Available in EPDM or Viton®)

Must specify EPDM (product # and E) or Viton® (product # and V) when ordering.

Tanks/Totes/Drums sold separately.

# 6 WAYS



# DURA-PUMP™ EASY CADDY CONVERSION KITS

For Use On **MONSANTO TANK**  
MTS Easy Caddy Conversion Kit DP-AK0008



Begin with the Dura Easy Caddy



Remove Dura-Pump™ from Easy Caddy frame

For Use On **SNYDER TANK**  
GEM Cap Easy Caddy Conversion Kit DP-AK0009



Begin with the Dura Easy Caddy



Remove Dura-Pump™ from Easy Caddy frame

For Recirculation On **IBC/TOTE**  
Recirculation Kit DP-AK0007



Begin with the Dura Easy Caddy



Add Recirculation Kit DP-AK0007

For Use On **55 GALLON DRUM**  
1" NPT Telescoping Downtube DP-T4001



Begin with the Dura Easy Caddy



Remove Dura-Pump™ from Easy Caddy frame



**AG DURA-PUMP™ GASKET KIT**  
DP-G4001A-E EPDM  
DP-G4001A-V Viton®



**AG DURA-PUMP™ BOTTOM HOUSING KIT WITH BOTTOM GASKET AND SCREWS**  
DP-H4001A-E EPDM  
DP-H4001A-V Viton®



**AG DURA-PUMP™ CARTRIDGE KIT WITH O-RING AND BOTTOM GASKET**  
DP-P4017A-E EPDM  
DP-P4017A-V Viton®



**AG DURA-METER™ CHEMICAL FACE PLATE**  
DP-MFP01



**AG DURA-METER™ BODY**  
DP-PMB3000E EPDM  
DP-PMB3000V Viton®



**FEMALE COUPLING DRY POPPET FOR N-SERVE SYSTEMS**  
DP-C4010N

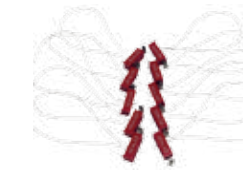

**TAMPER EVIDENT SEALS**  
DP-P5500 100 PACK  
DP-P5501 10 PACK



**2" CAMLOCK**  
DP-NF20CL



**MTS CAMLOCK**  
DP-M4001



**EASY SEAL DUAL ACTION AUTO VENT 2" NPT**  
DP-V4002



**5 GALLON CALIBRATION JUG**  
DP-J4001



**1" BALL VALVE NOZZLE**  
DP-NF4002



**1" REPLACEMENT T-HANDLE**  
DP-NF4004



**BUTTRESS TO NPT ADAPTER-2" X 2"**  
DP-A4001



**2" X 1" BUTTRESS MANUAL VENT**  
DP-V4001-B



**RECIRCULATION KIT FOR EASY CADDY AND QUICK CADDY**  
DP-AK0007

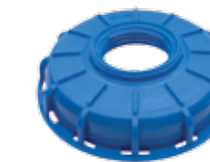

**6" IBC CAP WITH 2" BUTTRESS BUNG**  
DP-C4001B-E



**6" IBC CAP WITH DUAL ACTION VENT**  
DP-C4010B-E



**6" IBC CAP WITH 2" NPT BUNG**  
DP-C4009B-E



**6" IBC CAP WITH MANUAL VENTED LID AND 2" BUTTRESS BUNG**  
DP-C4004B-E

**1" NPT TELESCOPING DOWNTUBE DP-T4001**  
*(also used for Easy Caddy Conversion on 55 Gallon Drum)*



**MTS EASY CADDY CONVERSION KIT**  
DP-AK0008



**GEM CAP EASY CADDY CONVERSION KIT**  
DP-AK0009



**AG 135 GALLON CHEMICAL CAGE TANK**



**AG 275 GALLON CHEMICAL CAGE TANK**

*Tanks available upon request*



# DURA-LOAD STATION™

- / Reduction of agriculture sprayer load time by 75%
- / Payback of initial investment in less than 20-25 spraying days
- / With our 3" Dura-Load Station™, you can load a 1,000 gallon sprayer with up to 4 chemicals in 5 minutes
- / Electric valves allow for rapid injection of product into fill line with the flip of a switch
- / Optimized for repeatable batching; returns to the last volume amount dispensed



Load Station Contents	
Output Pump	3" Banjo Wet Seal Honda Motor
Fluid Inputs	Four (4) chemical
Input Pumps	Four (4) AG chemical 15GPM Dura-Pumps™
Inductor Valve	Electric
Operator Panel	Four (4) digital Dura-Meters™ OR Four (4) digital Auto-Batch Systems (ABS)
Tanks	Three (3) stainless steel: 70, 30 and 15 gallon
Other	All hose clamps, barbs and nipples

WITH Dura-ABS	WITHOUT Dura-ABS
DP-LS-ABS	DP-LS

(Available in EPDM or Viton®)



Add MTS Kit DP-AK0008 (found on page 15)



Dura MTS Kit DP-AK0008 installed on Monsanto tank



Add GEM Cap Kit DP-AK0009 (found on page 15)



Dura GEM Cap Kit DP-AK0009 installed on Snyder tank



Dura Recirculation Kit DP-AK0007 installed on IBC/TOTE (found on page 15)



Add DP-T4001: 1" NPT Telescoping Downtube (found on page 15)



DP-T4001: 1" NPT Telescoping Downtube installed on 55 Gallon Drum





# DURA-PUMP™

# SPECIALTY SYSTEMS

## DURA-PUMP™ QUICK CADDY



- / Our premium highly portable system with built-in carry handle and rugged frame
- / For use in multiple mounting applications both on top of tote and ground adaptable
- / Includes 2 Year Warranty

WITH Meter	WITHOUT Meter
DPQM-4312 12 Volt	DPQ-4012 12 Volt
DPQM-4315 110 Volt	DPQ-4015 110 Volt

(Available in EPDM or Viton®)

Must specify EPDM (product # and E) or Viton® (product # and V) when ordering.

Tanks/Totes/Drums sold separately.

## DURA-PUMP™ TOP UNLOAD



- / Top mount application with 2" NPT bung, 1" telescoping downtube to accommodate varying tank heights
- / Includes 2 Year Warranty

WITH Meter	WITHOUT Meter
DPTM-4312 12 Volt	DPT-4012 12 Volt
DPTM-4315 110 Volt	DPT-4015 110 Volt

(Available in EPDM or Viton®)

Must specify EPDM (product # and E) or Viton® (product # and V) when ordering.

Tanks/Totes/Drums sold separately.

## DURA-PUMP™ BOTTOM UNLOAD



- / Configured to be hard mounted at bottom of tank/tote
- / Includes 2 Year Warranty

WITH Meter	WITHOUT Meter
DPBM-4312 12 Volt	DPB-4012 12 Volt
DPBM-4315 110 Volt	DPB-4015 110 Volt

(Available in EPDM or Viton®)

Must specify EPDM (product # and E) or Viton® (product # and V) when ordering.

Tanks/Totes/Drums sold separately.



### Pumping System Contains

Pump	High-Flow Dura-Pump™
Suction Hose	1" x 5ft
Discharge Hose	1" x 12ft
Nozzle	Ball valve
Camlock	2"
Meter	Dura-Meter™ (optional)
Other	All hose clamps, barbs and nipples



### Pumping System Contains

Pump	High-Flow Dura-Pump™
Discharge Hose	1" x 12ft
Downtube	1" Telescoping
Nozzle	Ball valve
Meter	Dura-Meter™ (optional)
Other	All hose clamps, barbs and nipples



### Pumping System Contains

Pump	High-Flow Dura-Pump™
Discharge Hose	1" x 12ft
Camlock	2"; direct attach to tote
Motor Bracket	Yes, rear
Nozzle	Ball valve
Meter	Dura-Meter™ (optional)
Other	All hose clamps, barbs and nipples



For use with Monsanto tanks

## MONSANTO TANK



WITH Meter	WITHOUT Meter
DPMTSM-4312 12 Volt	DPMTS-4012 12 Volt
DPMTSM-4315 110 Volt	DPMTS-4015 110 Volt

(Available in EPDM or Viton®)

Must specify EPDM (product # and E) or Viton® (product # and V) when ordering.

Pumping System Contains	
Pump	High-Flow Dura-Pump™
Discharge Hose	1" x 12ft
Camlock	MTS; direct attach to tote
Motor Bracket	Yes, rear
Nozzle	Ball valve
Meter	Dura-Meter™ (optional)
Other	All hose clamps, barbs and nipples

/ Includes 2 Year Warranty



For use with Snyder tanks with large 8" lid

## SNYDER / GEM CAP TANK



WITH Meter	WITHOUT Meter
DPGEMM-4312 12 Volt	DPGEM-4012 12 Volt
DPGEMM-4315 110 Volt	DPGEM-4015 110 Volt

(Available in EPDM or Viton®)

Must specify EPDM (product # and E) or Viton® (product # and V) when ordering.

Pumping System Contains	
Pump	High-Flow Dura-Pump™
Discharge Hose	1" x 12ft
GEM Cap Lid	Spin collar; all plumbing assembled on pump
Motor Bracket	Yes; rear
Downtube	1" Telescoping
Nozzle	Ball valve
Meter	Dura-Meter™ (optional)
Other	All hose clamps, barbs and nipples

/ Includes 2 Year Warranty



WITH Meter	WITHOUT Meter
DPEM-4612NV 12 Volt	DPE-4612NV 12 Volt
DPEM-4615NV 110 Volt	DPE-4615NV 110 Volt

Easy Caddy pumping system in Viton®

## N-SERVE EASY CADDY

### Pumping System Contains

Pump	High-Flow Dura-Pump™
Discharge Hose	1" x 12ft; Premium XPLE
Suction Hose	1" x 5ft; Premium XPLE
Dry-Poppet Coupler	Available; sold separately (see right)
Nozzle	Ball valve
Meter	Dura-Meter™ (optional)
Other	All hose clamps, barbs, nipples

/ Includes 2 Year Warranty



Female Coupling Dry Poppet DP-C4010N sold separately

## N-SERVE BOTTOM UNLOAD

### Pumping System Contains

Pump	High-Flow Dura-Pump™
Discharge Hose	1" x 12ft; Premium XPLE
Motor Bracket	Yes; rear
Dry-Poppet Coupler	Available; sold separately (see right)
Nozzle	Ball valve
Meter	Dura-Meter™ (optional)
Other	All hose clamps, barbs, nipples

/ Includes 2 Year Warranty



Female Coupling Dry Poppet DP-C4010N sold separately



WITH Meter	WITHOUT Meter
DPBM-4312NV 12 Volt	DPB-4012NV 12 Volt
DPBM-4315NV 110 Volt	DPB-4015NV 110 Volt

Bottom Unload pumping system in Viton®