

DURA-METER™

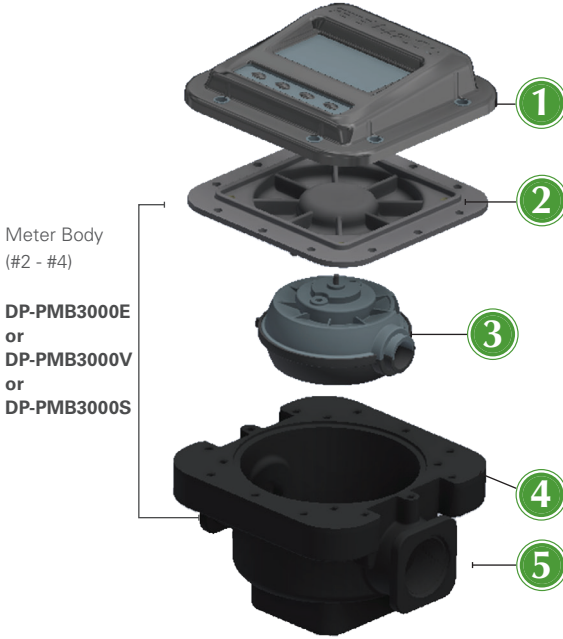

- Made of impact resistant Lexan™ faceplate
- 100% moisture-sealed circuitry
- Menu driven backlit display
- Plumbed both for in-line and 90-degree applications
- Includes a 2-year Warranty & Maintenance Program

- 1** Meter Faceplate
DP-MFP01
- 2** Housing Cover Plate **DP-M1103D**
- 3** Nutating Chamber
DP-NC-3000E/V/S
(Viton®, EPDM, or Silicone)
- 4** Meter Housing
DP M1102D
- 5** Coverplate O-Ring
DP M-1106O-E/V/S *(Viton®, EPDM, or Silicone)*

Nutating O-Ring
DP-M-1107O-E/V/S *(Viton®, EPDM, or Silicone)*

SPECIFICATIONS

Operating Temp	-10°F to 130°F, -23°C to 54°C
Flow Rate	2 to 20 GPM, 7.5 to 75.7 LPM
Meter Accuracy	+ / - .5%
Backlit Display	Yes
Maximum Pressure	40 PSI
Wetted Materials	Polypropylene; 304 Stainless Steel; Ryton; Viton®, EPDM, or Silicone seals

ORDERING INFORMATION

DP-3000V
Viton®

DP-3000E
EPDM

DP-3000S
Silicone