

DURA PRODUCTS

6000 SERIES HIGH-FLOW  
DURA-PUMP™



- High-Flow with up to 18GPM/68LPM flow rate; a 20% improvement in flow rate over our previous pump
- Newly redesigned, simplified cartridge for easier serviceability
- Self-priming diaphragm pump with internal by-pass
- Motor thermally protected from overheating
- 30-minute duty cycle
- Suction port has 2" Male NPT and 1" Female NPT
- Includes a 2-year Warranty & Maintenance Program

ORDERING INFORMATION	
12 VOLT DURA-PUMP™	110 VOLT DURA-PUMP™
DP-6018V-12 Viton®	DP-6018V-110 Viton®
DP-6018E-12 EPDM	DP-6018E-110 EPDM
DP-6018S-12 Silicone	DP-6018S-110 Silicone

DP-HEATSINK Pump Heat Sink

Always turn pump off and disconnect system from power when not in use.

SPECIFICATIONS	
Vertical Suction Lift	Self-priming to 10ft, 3m
Power Cord	12 Volt: 18ft, 5.5m; 110 Volt: 6.5ft, 2m
Motor	1/4 HP, 240W
Amps	12 Volt: 20.0; 110 Volt: 3.0
Suction Port	2" Male and 1" Female NPT thread
Discharge Port	1" Female NPT thread
Wetted Materials	Polypropylene; Santoprene; Viton®, EPDM or Silicone seals; 304 Stainless Steel, PVDF (Kynar)



PUMP HEAT SINK

- Extends duty cycle by 33% (Under normal operating conditions this means 30-40 minutes.)
- For high use operations or operations in a high heat setting.

# 6000 SERIES HIGH-FLOW DURA-PUMP™

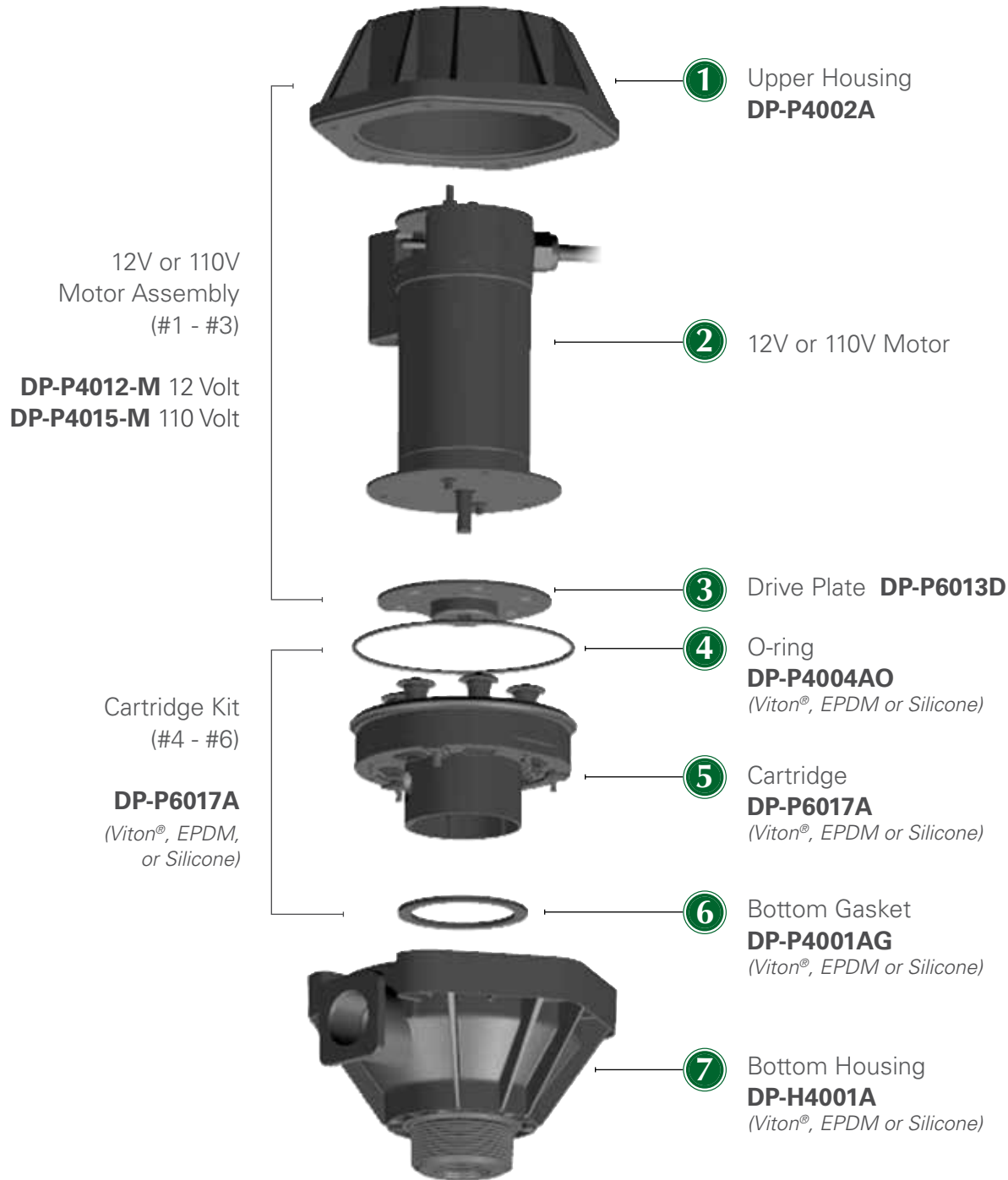

**DURA PRODUCTS**  
Technology with Lasting Value  
[www.DuraProducts.com](http://www.DuraProducts.com)  
Arcadia, IN 46030 | (317) 984-4003