



DURA PRODUCTS

Technology with Lasting Value

MINI CATALOG

Market Leader
in agricultural transfer systems



DURA PRODUCTS INTRODUCING OUR NEW 3" HIGH-FLOW DURA-METER™

- / Intuitive menu-driven backlit display
- / Impact resistant Lexan™ faceplate
- / 100% Moisture-sealed circuitry
- / 3" Manifold flanged meter body
- / Multiple plumbing options
- / Includes a 2-year Warranty & Maintenance Program



Moisture sealed circuitry.



SPECIFICATIONS

Nominal Size	3"
Model	Dura HFM 3
Batteries	(2) 9 Volt
Accuracy	+ / - 0.5%
Backlit Display	Yes
GPM	15 - 700
Wetted Materials	GF Polypropyl, Viton®, EPDM, or Silicone seal, Sapphire

ORDERING INFORMATION

DP-HFM3V Viton®

DP-HFM3E EPDM

DP-HFM3S Silicone

Must specify Viton® (product # and V), EPDM (product # and E), or Silicone (product # and S) when ordering.

3" HIGH-FLOW DURA-METER™



SPECIFICATIONS	
Nominal Size	3"
Model	DP-HFM3
Connection	M300 flange
Meter Accuracy	+/- 0.5%
Non-conductive Fluids	Yes
Fluid Flow Initiates Measurement	Yes
Batteries	(2) 9 Volt
Battery Life Indicator	Yes
Backlit Display	Yes
Minimum GPM	15
Maximum GPM	700
Minimum Temp	+ 32 °F
Maximum Temp	+ 140 °F
Battery Size/Voltage	9V
Meter Type/Style	Paddlewheel
Body Construction Material	GF Polypropyl
Paddle Bearing Construction Material	Sapphire
Straight Inlet Required *	30" *
Straight Outlet Required *	15" *
Field Calibration Capability *	Yes *

** Straight Inlet / Outlet Requirements can be significantly reduced with Meter Calibration to achieve +/- 0.5% Accuracy*

Special Features

- / Easily serviced
- / Extended battery life with use of (2) 9V batteries
- / Fluid flow initiates measurement
- / Versatile plumbing configurations
- / Displays batch and total volume
- / Gallons / Liters flow rate measurement

DURA-ABS™ AUTO-BATCH SYSTEM

"The system **reduces** human error and creates valuable **efficiency** for us."

-Peterson Farms, KY



How It Works

- 1 Select the volume desired
- 2 Press START
- 3 The pump will begin to dispense fluid then automatically shut off upon completion

- / Intuitive interface allows for the selection of manual or automatic operation with the flip of a switch
- / High-flow pump with up to 15GPM/56LPM flow rate
- / Optimized for repeatable batching; returns to the last volume amount dispensed
- / 100% moisture-sealed circuitry
- / Includes Dura-Meter™ with impact resistant Lexan™ faceplate
- / Available in 12 Volt or 110 Volt, and Viton®, EPDM, or Silicone options
- / Measures in gallons, liters and ounces
- / Includes a 2-year Warranty & Maintenance Program



"I've got six plumbed to an inductor. It **works** great, and **saves** me time when mixing batches."

-Don, Nutrien Ag Solutions

ORDERING INFORMATION

DPABS-4312 12 Volt

DPABS-4315 110 Volt

Must specify Viton® (product # and V), EPDM (product # and E), or Silicone (product # and S) when ordering.

Always turn pump off and disconnect system from power when not in use.

DURA-ABS™ Automated Direct Injection



AUTO-BATCH SYSTEM DIRECT INJECTION

The **Dura Auto-Batch System ** (*Automated Direct Injection*) works by direct injecting herbicides into the carrier flow while filling the sprayer.

Increase PROFITABILITY
with a Dura-ABS™  Direct Injection



How It Works

- 1 Select the volume desired
- 2 Press START
- 3 The pump will begin to inject fluid then automatically shut off upon completion



- / Lowest cost automated sprayer filling system
- / Filling your sprayer has never been easier or faster
- / Reduces operator error and herbicide exposure
- / Provides recirculation, maximizing chemical performance
- / Accurately dispenses repeatable batches
- / Eliminates cross contamination

Video available at www.DuraProducts.com/videos

ORDERING INFORMATION		
PRODUCT #	QTY	DESCRIPTION
DPABS-4312V**	1-4	DURA-ABS™ Auto-Batch System
Dura-ABS DI 2" Kit <i>OR</i> Dura-ABS DI 3" Kit	1-4 1 PER DURA-ABS™	2" Accessory Kit <i>OR</i> 3" Accessory Kit
Dura-ABS DI 2" Gauge Kit <i>OR</i> Dura-ABS DI 3" Gauge Kit	1	2" Gauge Kit <i>OR</i> 3" Gauge Kit
DP-P4040 DI	1	DI Frame

**Available in 12V or 110V with Viton®, EPDM, or Silicone Seals

*Always turn pump off and disconnect system from power when not in use.
Never leave unattended while in use.*

What a *Real User* is saying about the **DURA-ABS™ DI Direct Injection...**



Reduced our sprayer load time by more than 78%.
-Woodward Farms

AUTOMATED DIRECT INJECTION FILL USING DURA-ABS™ DI Austin Woodward / Woodward Farms

Hagie STS12, 1200 Gallon Capacity, 3" Plumbing

PRODUCTS DIRECT INJECTED			PRODUCTS INDUCED
Atrazine 4L	27.5 gal per fill	1 qtA	<i>Callisto (added from 1 gal jug)</i>
Durango DMA	20.5 gal per fill	1.5 ptA	<i>Zidua SC (added from 1 gal jug)</i>
Class Act NG	20.5 gal per fill	1.5 ptA	<i>Interlock (added from 2.5 gal jug)</i>

68.5 GALLONS OF PRODUCT INJECTED INTO CARRIER STREAM WITH DI

DURA-ABS™ DI Injection Time 3 minutes 45 seconds

Sprayer Fill Time 6 minutes 15 seconds

Woodward Farms video available at www.DuraProducts.com/videos

"When it comes to spraying we want to be safe and quick. With the Dura-ABS Automated Direct Injection, we not only have less exposure to chemicals, but we've reduced our sprayer load time by more than 78%."

- Austin Woodward, Woodward Farms

The **DURA-ABS™** **DI** Direct Injection gives you a high return on your investment.



Calculate your own Additional Spraying Capacity with the
DURA-ABS™ **DI** Direct Injection

Additional Spraying Capacity per Day		Woodward Farms Savings	Your Savings
System Sprayer Fill Time (mins)		20 min	
DURA-ABS DI Sprayer Fill Time (mins)	-	6.25 min	6.25
Mins Saved per Fill	=	13.75 min	
Fills per Day	x	5	
Mins Saved per Day	=	68.75 mins	
Acres Sprayed per Hour		100.00 ac	
Additional Capacity per Day*		115.00 ac	
Chemical Application Rate / Acre**	x	6.69	
Spraying Days	x	9.00	
Savings After 9 Spraying Days	=	\$ 6,924.15	\$

*minutes saved per day / 60 x acres sprayed per hour
 **2017 Indiana Farm Custom Rates (Purdue University)

Video available at
www.DuraProducts.com/videos

DURA-ABV™-B

**AUTOMATION
MADE EASY**

BANJO EVX® 100B*

AUTO-BATCH METER



ELECTRIC VALVE

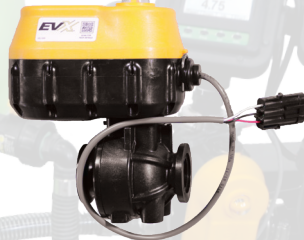

*Available in NPT or Manifold

SIMPLE

- / Join factory installed electric connectors
- / Plumb valve to Auto-Batch
- / Select volume desired
- / Press START
- / Banjo EVX® Valve will open, fluid is measured and valve automatically closes upon completion

SMART

- / Eliminates operator error and herbicide exposure
- / Real-time valve LED performance feedback
- / Inventory management
- / Female NPT and manifold flange connections offer plumbing options
- / Ability to save up to five calibrations and measure in gallons, liters and ounces

ECONOMICAL

- / Consists of a Dura-ABV™ and Banjo EVX® Valve
- / No sophisticated wiring, PLC or plumbing
- / Multiple units can be used in manifold application
- / Ideally suited with venturi driven chemical handling system



DURA-ABV™ AND BANJO EVX®



How It Works

- 1 Select the volume desired
- 2 Press START
- 3 Banjo EVX® Valve will open, fluid is measured and valve automatically closes upon completion

Video available at
www.DuraProducts.com/videos



DURA-ABV™-B TECHNICAL SPECIFICATIONS

Operating Temp	-10° F to 130° F, -23° C to 54° C
Flow Rate	2 to 22GPM, 7.5 to 83LPM
Meter Accuracy	+/- .5%
Backlit LCD Display	Yes; with back-light timeout
Max Pressure	40 PSI
Power Source	4 "AAA" batteries; strength indicator
Wetted Materials	Polypropylene; 304 Stainless Steel; Rytan; Viton® seals
Housing Chamber	Polypropylene
Moisture Sealed	Yes; with sealed circuitry
Batch Count	Yes
Total Count	Yes
Units Measured	Gallons, Liters and Ounces
Chemically Resistant	Yes
Calibration	Preset, Quick List or Manual
Saved Calibrations	5
Dimensions	5-1/4" W x 7-1/4" H x 4-1/4" D
Weight	1.5 lbs

ORDERING INFORMATION

PRODUCT

DURA-ABV-B

DESCRIPTION

Dura-ABV™ Auto-Batch Meter with Banjo Connector

Always turn pump off and disconnect system from power when not in use.

Never leave unattended while in use.



DURA-METER™

- / Made of impact resistant Lexan™ faceplate
- / 100% moisture-sealed circuitry
- / Menu driven backlit display
- / Plumbed both for in-line and 90-degree applications
- / Includes a 2-year Warranty & Maintenance Program



SPECIFICATIONS	
Operating Temp	-10°F to 130°F, -23°C to 54°C
Flow Rate	2 to 22GPM, 7.5 to 83LPM
Meter Accuracy	+ / - .5%
Backlit Display	Yes
Maximum Pressure	40 PSI
Wetted Materials	Polypropylene; 304 Stainless Steel; Rytan; Viton®, EPDM, or Silicone seals

Special Features

- / Extended battery life with use of 4 "AAA" batteries
- / Faceplate over-molded with Santoprene and filled with gel for improved shock resistance



Customer should always check calibration before use.

ORDERING INFORMATION

DP-3000V Viton®

DP-3000E EPDM

DP-3000S Silicone



DURA-PUMP™

- / High-Flow with up to 15GPM/56LPM flow rate
- / Self-priming diaphragm pump with internal by-pass
- / Motor thermally protected from overheating
- / 30-minute duty cycle
- / Suction port has 2" Male NPT and 1" Female NPT
- / Pump is easily field serviceable
- / Includes a 2-year Warranty & Maintenance Program

SPECIFICATIONS

Check Valve	Internal; EPA 165.45 compliant
Vertical Suction Lift	Self-priming to 10ft, 3m
Power Cord	12 Volt: 20ft, 6m; 110 Volt: 6.5ft, 2m
Motor	1/4 HP, 186W
Amps	12 Volt: 18.5; 110 Volt: 2.0
Suction Port	2" Male and 1" Female NPT thread
Discharge Port	1" Female NPT thread
Wetted Materials	Polypropylene; Santoprene; Viton®, EPDM, or Silicone seals; 304 Stainless Steel

ORDERING INFORMATION

DP-4012 12 Volt **DP-4015** 110 Volt

(Available in Viton®, EPDM, or Silicone)

Must specify Viton® (**product # and V**),
EPDM (**product # and E**), or
Silicone (**product # and S**) when ordering.

Always turn pump off and disconnect
system from power when not in use.

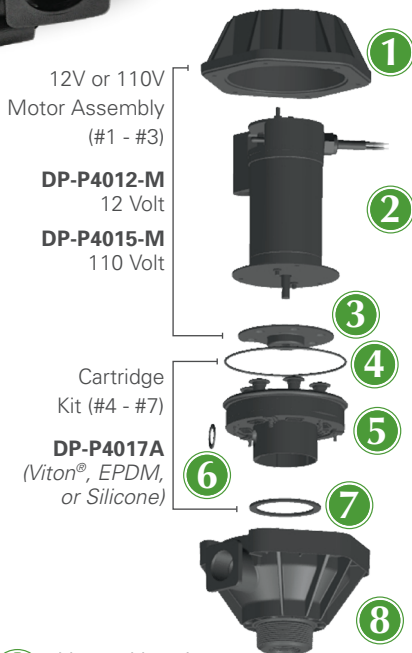

- 1** Upper Housing
DP-P4002A
- 2** 12V or 110V Motor
DP-P4012-M 12 Volt
DP-P4015-M 110 Volt
- 3** Drive Plate **DP-P4013A**
- 4** O-ring
DP-P4004AO (Viton®, EPDM, or Silicone)
- 5** Cartridge
DP-P4017A (Viton®, EPDM, or Silicone)
- 6** Bypass Gasket
DP-G4008AG (Viton®, EPDM, or Silicone)
- 7** Bottom Gasket
DP-P4001AG (Viton®, EPDM, or Silicone)
- 8** Bottom Housing
DP-H4001A (Viton®, EPDM, or Silicone)

DURA-PUMP™ EASY CADDY



TOP MOUNT
Easy Caddy secured
on top of tote



SIDE MOUNT
Easy Caddy secured
on side of tote



GROUND
Easy Caddy used
from the ground



DRUM
Easily converted
to a 30/55-Gallon
Drum

1 SYSTEM USE IT 6 WAYS

- / The Easy Caddy can be mounted in four different configurations on a variety of tank/tote and drum types
- / Use it mounted on top of a tank or on top of a 30/55-Gallon Drum, on the side of tank, or off the ground depending on user preference
- / Conversion kits are available to mount a system on Monsanto or Snyder type tanks
- / Includes a 2-year Warranty & Maintenance Program



MONSANTO TANK
Easily converted to a MTS



SNYDER TANK
Easily converted
to a GEM Cap

ORDERING INFORMATION	
WITH METER	WITHOUT METER
DPEM-4312 12 Volt	DPE-4012 12 Volt
DPEM-4315 110 Volt	DPE-4015 110 Volt

Must specify Viton® (**product # and V**),
EPDM (**product # and E**), or
Silicone (**product # and S**) when ordering.

Always turn pump off and disconnect
from power when not in use.

Tanks, Totes and Drums sold separately.



PUMPING SYSTEM CONTAINS	
Pump	High-Flow Dura-Pump™
Suction Hose	1" x 5ft, 1.5m
Discharge Hose	1" x 12ft, 3.6m
Nozzle	Ball valve
Camlock	2"
Meter	Dura-Meter™ (optional)
Other	All hose clamps, barsbs and nipples

DURA-PUMP™ EASY CADDY CONVERSION KITS

For Use On **MONSANTO TANK**
MTS Easy Caddy Conversion Kit **DP-AK0008**



Begin with the
Dura Easy Caddy



Remove Dura-Pump™
from Easy Caddy frame



Add MTS Kit
DP-AK0008



Dura MTS Kit
DP-AK0008 installed
on Monsanto tank

For Use On **SNYDER TANK**
GEM Cap Easy Caddy Conversion Kit **DP-AK0009**



Begin with the
Dura Easy Caddy



Remove Dura-Pump™
from Easy Caddy frame



Add GEM Cap Kit
DP-AK0009



Dura GEM Cap Kit
DP-AK0009 installed
on Snyder tank

For Recirculation On **IBC/TOTE**
Recirculation Kit **DP-AK0007**

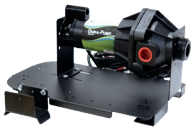

Begin with the
Dura Easy Caddy



Add Recirculation Kit
DP-AK0007



Dura Recirculation Kit
DP-AK0007 installed
on IBC/TOTE

For Use On **30/55-GALLON DRUM**
1" NPT Telescoping Downtube **DP-T4001**



Begin with the
Dura Easy Caddy



Remove Dura-Pump™
from Easy Caddy frame



Add DP-T4001
1" NPT Telescoping
Downtube



DP-T4001
1" NPT Telescoping
Downtube installed on
30/55-Gallon Drum

DURA-PUMP™ SPECIALTY SYSTEMS

Tanks, Totes and Drums sold separately. Always turn pump off and disconnect from power when not in use.



DURA-PUMP™ QUICK CADDY

- / Our premium highly portable system with built-in carry handle and rugged frame
- / For use in multiple mounting applications both on top of tote and ground adaptable
- / Includes a 2-year Warranty & Maintenance Program

ORDERING INFORMATION	
WITH METER	WITHOUT METER
DPQM-4312 12 Volt	DPQ-4012 12 Volt
DPQM-4315 110 Volt	DPQ-4015 110 Volt

Must specify Viton® (product # and V) or EPDM (product # and E) when ordering.



PUMPING SYSTEM CONTAINS	
Pump	High-Flow Dura-Pump™
Suction Hose	1" x 5ft, 1.5m
Discharge Hose	1" x 12ft, 3.6m
Nozzle	Ball valve
CamLock	2"
Meter	Dura-Meter™ (optional)
Other	All hose clamps, barbs and nipples



DURA-PUMP™ TOP UNLOAD

- / Top mount application with 2" NPT bung, 1" telescoping downtube to accommodate varying tank heights
- / Includes a 2-year Warranty & Maintenance Program

ORDERING INFORMATION	
WITH METER	WITHOUT METER
DPTM-4312 12 Volt	DPT-4012 12 Volt
DPTM-4315 110 Volt	DPT-4015 110 Volt

Must specify Viton® (product # and V) or EPDM (product # and E) when ordering.



PUMPING SYSTEM CONTAINS	
Pump	High-Flow Dura-Pump™
Discharge Hose	1" x 12ft, 3.6m
Downtube	1" Telescoping
Nozzle	Ball valve
Meter	Dura-Meter™ (optional)
Other	All hose clamps, barbs and nipples



DURA-PUMP™ BOTTOM UNLOAD

- / Configured to mount at bottom of tank/tote
- / Includes a 2-year Warranty & Maintenance Program

ORDERING INFORMATION	
WITH METER	WITHOUT METER
DPBM-4312 12 Volt	DPB-4012 12 Volt
DPBM-4315 110 Volt	DPB-4015 110 Volt

Must specify Viton® (product # and V) or EPDM (product # and E) when ordering.



PUMPING SYSTEM CONTAINS	
Pump	High-Flow Dura-Pump™
Discharge Hose	1" x 12ft, 3.6m
CamLock	2"; direct attach to tote
Motor Bracket	Yes, rear
Nozzle	Ball valve
Meter	Dura-Meter™ (optional)
Other	All hose clamps, barbs and nipples

DURA-PUMP™ SPECIALTY SYSTEMS

Tanks, Totes and Drums sold separately. Always turn pump off and disconnect from power when not in use.

MONSANTO TANK



For use with Monsanto tanks



ORDERING INFORMATION	
WITH METER	WITHOUT METER
DPMTSM-4312 12 Volt	DPMTS-4012 12 Volt
DPMTSM-4315 110 Volt	DPMTS-4015 110 Volt

Must specify Viton® (product # and V) or EPDM (product # and E) when ordering.

PUMPING SYSTEM CONTAINS	
Pump	High-Flow Dura-Pump™
Discharge Hose	1" x 12ft, 3.6m
Camlock	MTS; direct attach to tote
Motor Bracket	Yes, rear
Nozzle	Ball valve
Meter	Dura-Meter™ (optional)
Other	All hose clamps, bars and nipples

/ Includes a 2-year Warranty & Maintenance Program

SNYDER / GEM CAP TANK



For use with Snyder tanks with large 8" lid



ORDERING INFORMATION	
WITH METER	WITHOUT METER
DPGEMM-4312 12 Volt	DPGEM-4012 12 Volt
DPGEMM-4315 110 Volt	DPGEM-4015 110 Volt

Must specify Viton® (product # and V) or EPDM (product # and E) when ordering.

PUMPING SYSTEM CONTAINS	
Pump	High-Flow Dura-Pump™
Discharge Hose	1" x 12ft, 3.6m
GEM Cap Lid	Spin collar; all plumbing assembled on pump
Motor Bracket	Yes; rear
Downtube	1" Telescoping
Nozzle	Ball valve
Meter	Dura-Meter™ (optional)
Other	All hose clamps, bars and nipples

/ Includes a 2-year Warranty & Maintenance Program



ORDERING INFORMATION	
WITH METER	WITHOUT METER
DPEM-4612NV 12 Volt	DPE-4612NV 12 Volt
DPEM-4615NV 110 Volt	DPE-4615NV 110 Volt

Easy Caddy pumping system in Viton®

N-SERVE EASY CADDY

PUMPING SYSTEM CONTAINS	
Pump	High-Flow Dura-Pump™
Discharge Hose	1" x 12ft, 3.6m; Premium XLPE
Suction Hose	1" x 5ft, 1.5m; Premium XLPE
Dry-Poppet Coupler	Available; sold separately (see right)
Nozzle	Ball valve
Meter	Dura-Meter™ (optional)
Other	All hose clamps, bars and nipples



Female Coupling
Dry Poppet
DP-C4010N
sold separately

/ Includes a 2-year Warranty & Maintenance Program



ORDERING INFORMATION	
WITH METER	WITHOUT METER
DPBM-4312NV 12 Volt	DPB-4012NV 12 Volt
DPBM-4315NV 110 Volt	DPB-4015NV 110 Volt

Bottom Unload pumping system in Viton®

N-SERVE BOTTOM UNLOAD

PUMPING SYSTEM CONTAINS	
Pump	High-Flow Dura-Pump™
Discharge Hose	1" x 12ft, 3.6m; Premium XLPE
Motor Bracket	Yes; rear
Dry-Poppet Coupler	Available; sold separately (see right)
Nozzle	Ball valve
Meter	Dura-Meter™ (optional)
Other	All hose clamps, bars and nipples



Female Coupling
Dry Poppet
DP-C4010N
sold separately

/ Includes a 2-year Warranty & Maintenance Program



DEF DURA-METER™

- / Made of impact resistant Lexan™ faceplate
- / 100% moisture-sealed circuitry
- / Same great menu driven backlit display
- / Plumbed for both in-line and 90 degree applications
- / Includes a 2-year Warranty & Maintenance Program



ORDERING INFORMATION
DP-3000D

SPECIFICATIONS	
Operating Temp	-10°F to 130°F, -23°C to 54°C
Flow Rate	2 to 22GPM, 4 to 44LPM
ISO22241-3 Compliant	Yes
Meter Accuracy	+ / - .5%
Maximum Pressure	40 PSI
Wetted Materials	Polypropylene; 304 Stainless Steel; Ryton; EPDM seals



DEF DURA-PUMP™

- / High-Flow pump with up to 15GPM/56LPM free flow rate and 10+GPM/40+LPM with ¾" discharge hose and nozzle
- / Self-priming diaphragm pump with internal bypass
- / Motor thermally protected from overheating
- / 30-minute duty cycle
- / Suction port has 2" Male NPT and 1" Female NPT
- / Pump is easily field serviceable
- / 10-minute auto-shut off motor (available in 110V only)
- / Includes a 2-year Warranty & Maintenance Program

ORDERING INFORMATION
DEF-2012E 12 Volt **DEF-2015E** 110 Volt

SPECIFICATIONS	
Check Valve	Internal; EPA 165.45 compliant
Vertical Suction Lift	Self-priming to 10ft, 3m
Power Cord	12 Volt: 20ft, 6m; 110 Volt: 6.5ft, 2m
Motor	1/4 HP, 186W
Amps	12 Volt: 18.5; 110 Volt: 2.0
Suction Port	2" Male and 1" Female NPT thread
Discharge Port	1" Female NPT thread
ISO22241-3 Compliant	Yes
Wetted Materials	Polypropylene; Santoprene; 304 Stainless Steel; EPDM seals

DEF DURA-PUMP™ EASY CADDY TOP SUCTION

For totes with RPV type valve

PUMPING SYSTEM CONTAINS	
10+GPM Pump	High-Flow Dura-Pump™
Coupler	RPV; MicroMatic
Discharge Hose	3/4" x 20ft, 6m
Suction Hose	3/4" x 1.5ft, 0.5m
Nozzle	Manual or Automatic
Meter	DEF Dura-Meter™ (optional)
Other	All hose clamps and fittings

/ Includes a 2-year Warranty & Maintenance Program



TOP MOUNT
Easy Caddy secured on
top of a 330 tote

ORDERING INFORMATION	
MANUAL NOZZLE	
DEFE-2512ME	12 Volt
DEFE-2515ME	110 Volt
AUTOMATIC NOZZLE	
DEFE-2512AE	12 Volt
DEFE-2515AE	110 Volt
DEF Dura-Meter™ DP-3000D (sold separately)	



Meter, Totes, Drums, Lid and
Container Valves sold separately.

DEF DURA-PUMP™ TOP UNLOAD

PUMPING SYSTEM CONTAINS	
10+GPM Pump	High-Flow Dura-Pump™
Downtube	1" Telescoping
Nozzle	Manual or Automatic
Discharge Hose	3/4" x 20ft, 6m
Meter	DEF Dura-Meter™ (optional)
Other	All hose clamps and fittings

/ Includes a 2-year Warranty & Maintenance Program

ORDERING INFORMATION	
MANUAL NOZZLE	
DEFT-2012ME	12 Volt
DEFT-2015ME	110 Volt
AUTOMATIC NOZZLE	
DEFT-2012AE	12 Volt
DEFT-2015AE	110 Volt
DEF Dura-Meter™ DP-3000D (sold separately)	



Meter, Totes, Drums
and Lid sold
separately.

DEF DURA-PUMP™ 135 PORTABLE TOTE COMPLETE SYSTEM to TRANSPORT, DISPENSE & STORE DIESEL EXHAUST FLUID

PUMPING SYSTEM CONTAINS	
135-Gallon Tote	Specially designed to maintain the strictest purity of DEF
Pump System	ISO/EPA compliant DEF Easy Caddy pumping system
Coupler	RPV; MicroMatic
Discharge Hose	3/4" x 20ft, 6m
Suction Hose	3/4" x 1.5ft, 0.5m
Lid	6"; Vented
Nozzle	Manual or Automatic
Meter	DEF Dura-Meter™ (optional)
Other	All hose clamps and fittings

/ Includes a 2-year Warranty & Maintenance Program



ALL- IN-1

ORDERING INFORMATION	
MANUAL NOZZLE	
DEFE-2512ME-135	12 Volt
DEFE-2515ME-135	110 Volt
AUTOMATIC NOZZLE	
DEFE-2512AE-135	12 Volt
DEFE-2515AE-135	110 Volt
DEF Dura-Meter™ DP-3000D (sold separately)	



Tote, Lid and Container
Valve INCLUDED.

DURA-AB™

AUTO-BATCH METER



NOW SOLD SEPARATELY

Upgrade your DURA-PUMP™ to an AUTO-BATCH SYSTEM

ORDERING INFORMATION	
PRODUCT #	DESCRIPTION
DPAB-12 12 Volt	Dura-Meter™ with Auto-Batch
DPAB-15 110 Volt	Dura-Meter™ with Auto-Batch

Must specify Viton® (**product # and V**), EPDM (**product # and E**), or Silicone (**product # and S**) when ordering.

Always turn pump off and disconnect system from power when not in use.
Never leave unattended while in use.

AG ACCESSORIES, PARTS, REPAIR KITS & TANKS

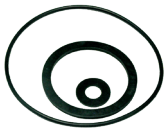

AG Dura-Pump™
Gasket Kit

DP-G4001A-V Viton®
DP-G4001A-E EPDM
DP-G4001A-S Silicone



AG Dura-Pump™ Bottom Housing
Kit with Bottom Gasket and Screws

DP-H4001A-V Viton®
DP-H4001A-E EPDM
DP-H4001A-S Silicone



AG Dura-Pump™ Cartridge KIT
with O-Ring and Bottom Gasket

DP-P4017A-V Viton®
DP-P4017A-E EPDM
DP-P4017A-S Silicone



AG Dura-Meter™
Chemical Face Plate
DP-MFP01



AG Dura-Meter™ Body
DP-PMB3000V Viton®
DP-PMB3000E EPDM
DP-PMB3000S Silicone



RSV / 3 Key
Dispense Coupler,
Viton Seals
DP-R4003



5-Gallon Calibration Jug
DP-J4001



2" Camlock
DP-NF20CL



MTS Camlock
DP-M4001



135-Gallon Tank
DP-AG135

DURA PRODUCTS AG CHEMICAL CHART

COMPOUND	EPDM	Viton®	Silicone
2,4-D Ester		●	
Accord® / Accord® XRT II	●	●	●
Acuron®	●		
Ammonium Sulfate	●	●	●
Atrazine	●	●	
Balance® Flexx	●	●	
Boundary®		●	
Callisto® 480SC	●		
Capreno®	●	●	
Corvus®	●	●	
Degree Xtra®	●	●	
Dicamba / Xtendimax®	●		
DiFlexx® Duo	●	●	
Duramax® / Durango®	●	●	●
Engenia®	●		
Enlist Duo®	●	●	●
EverGol®	●	●	
Foliars		●	
ForeFront®	●		
FulTime® NXT		●	
Fungicides		●	
Garlon® 3A	●		●
Gaucho® 600	●	●	
Gramoxone® / Paraquat		●	
Grazon® P+D / GrazonNext	●		
Halex® GT	●		
Huskie®		●	
Instinct®			●

COMPOUND	EPDM	Viton®	Silicone
Intimidator®	●		●
Keystone® / Keystone® LA			●
Laudis®	●	●	
Lexar® EZ / Lumax® EZ	●		
Liberty®	●		
Lorsban® 4E / Lorsban® Advanced		●	
Matador®	●		●
Max-In® Ultra ZMB	●	●	
MSO / Crop Oil / Oil Based		●	
Nitrogen Based		●	
N-Serve® 24		●	
Parity™		●	
Prosaro®	●	●	
Prowl® / Pendimethalin		●	
Raxil® PRO	●	●	
Rely® 280	●	●	
Resicore®			●
Roundup®	●	●	
Shredder™ E-99		●	
Stratego® / Stratego® YLD	●		
Stylet-Oil		●	
SureStart® / SureStart® II			●
Surpass® EC	●		●
Tacoma®		●	
TopNotch®	●		
Tordon® 22k	●		
Warrant®		●	
Wolverine® Advanced		●	

The Dura Products Chemical Compatibility Chart **should be considered as a guide only** due to the many variables which may affect the compatibility of materials. This guide is based on the most recent information obtained from a variety of suppliers and chemical producers and is believed to be accurate. Actual decisions on materials used need to be tested and evaluated by the customer for each specific application. The responsibility of proper chemical compatibility of equipment and material used is the full responsibility of the customer. Dura Products does not warrant product damaged by non compatibility.

For help with the proper selection of a pump for your application needs, please call (317) 984-4003.



DURA PRODUCTS

Technology with Lasting Value

PO Box 380
504 Demoss Ave
Arcadia, IN 46030
(317) 984-4003

www.DuraProducts.com

